

TECHNICAL DATASHEET



TRANSITION ADAPTOR PE-STEEL

01 Update - 12/2024

TECHNICAL DATA

Article No	001 117 6180 0110
d (mm)	110
R (inch)	4"
le (mm)	156
Z (mm)	596
s1 (mm)	10,0
s2 (mm)	6,0
Weight (Kg)	7,545
Box Quantity (pcs)	2
Box Dimension (pcs)	26x61x17,5

INJECTION MOULDED

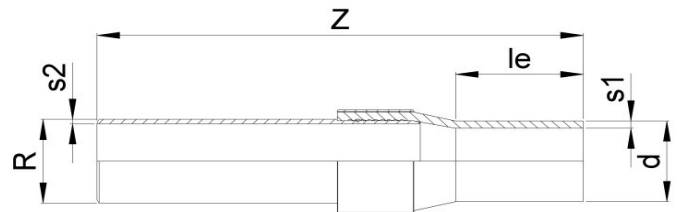
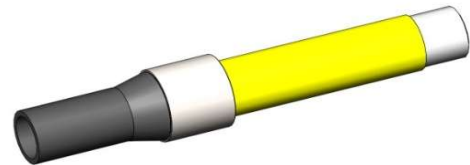

IDENTIFICATION OF PRODUCT

D	110x4
SDR	11
RAW METARIAL	PE 100
PRESSURE CLASS	16 Bar Water 10 Bar Gas
TRADEMARK	NTG
EXECUTION	Injection Moulded
STANDARD	TS ISO 17885

SPECIFICATION

Long Spigot
Welding end
Steel pipe GR-B API 5L DIN30670 PE coated for corrosion resistance
PE part injected

Tolerance on diameters and thickness according to the standards. The other dimensions are specialized. Tolerance $\pm 5\%$. NTG PLASTIK reserves all the right to change any information without giving prior notice. The production, distribution and utilization of this document without explicit authorization is prohibited.

Fr 161 Rev 00